



KS-C1

User

Manual

Cautions

Thanks for choosing KS-C1!

The scooter is especially designed for smooth and safe riding. It combines the power electricity and the style of a traditional scooter. enjoy an effortless gliding experience on this cool, ultra-lightweight, and easy to fold scooter.

Before you start, make sure the ride meets the age, height and weight requirements below.



KS-C1
6-12 years
≤ 40kg
120-140cm

WARNING

To reduce the risk of injury, adult supervision is required. Never use in roadways, near motor vehicles, on or near steep inclines or steps, swimming pools or other bodies of water; always wear shoes, and never allow more than 1 rider.

Contents

1. Device and accessories-----	01
2. Button usage-----	04
3. Assembly and set-up-----	05
4. Pre-ride checklist-----	06
5. Learn to ride-----	07
6. Warnings and cautions-----	11
7. Folding and unfolding-----	13
8. Battery-----	13
9. Clean and Maintenance-----	15
10. Warranty-----	16

1. The Device & Accessories

1.1 Diagram: KS-C1

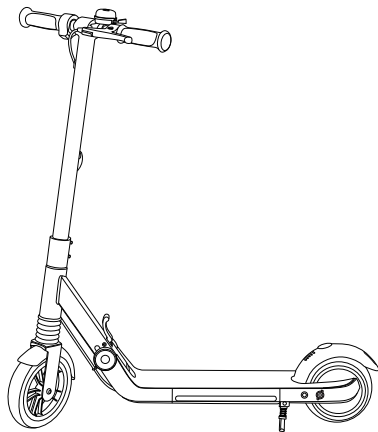

Accessories



Hex Wrench



Charging Adapter



User manual

1.2 Functions

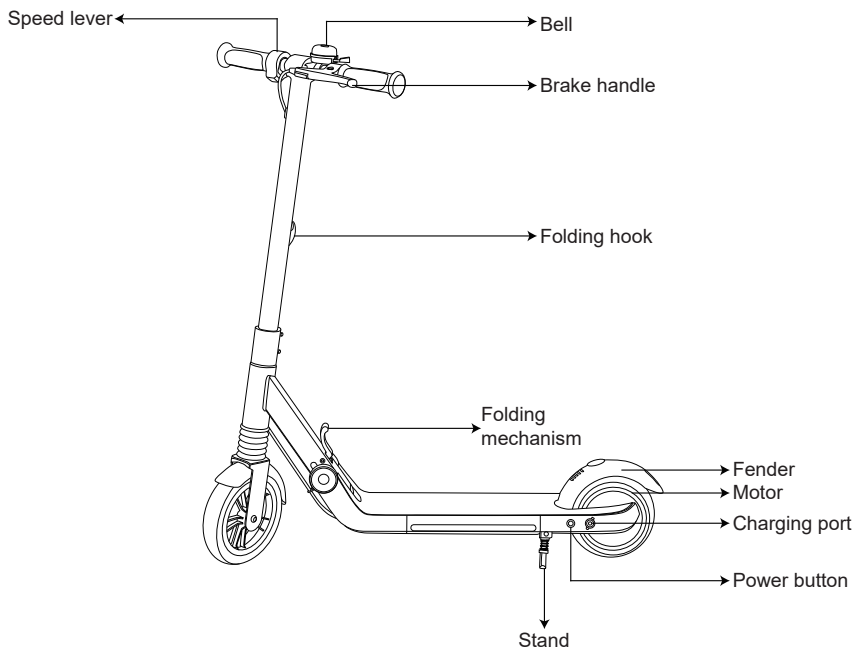

1.3 Specifications

Model No	KS-C1
Size	Front 7inch Tyre+Rear 5.5inch Tyre
Top Speed	12 km/h
Mileage	Around 10km
Gradeability	Around 8°
Battery Capacity	25.9V, 2.5Ah
Running Condition	-10 ℃/+45 ℃ ; 0-75% Humidity
Storage Condition	-20 ℃/+50 ℃ ; 0-75% Humidity
Max Load	40kg
Charger	Input: 100-240V; Output: 29.4V/0.8A(EU);29.4V/0.6A(UK)
Charging Time	Around 3-4hrs.
Motor	150W
Port	Charge Port *1
Parking Mode	Kick-stand
Reminder	Mechanical Bell

User Height	120-140cm
Accelerator	Throttle Button
Brake	E-ABS + Mechanical Brake
Dimension(Unfold)	830*370*910mm
Dimension(Folded)	910*370*310mm
Net Weight	8kg
Packing List(pcs)	User Manual*1, Certificate*1, Charger*1, Hex Wrench*1

2. Button Usage

- Power ON/OFF: Long press the button for 3 seconds.
- Under the boot state, press the power button for two times to switch the scooter power induction mode riding.

3. Assembly and Set-up

1. Slightly loosen the bolts on the collar clamp.

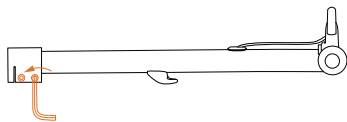

2. Slide the stem in to the marked length.

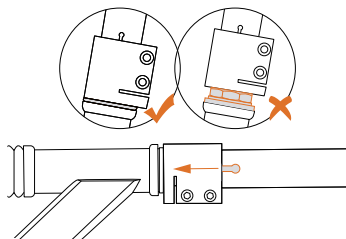

3. Park with the kickstand. Step on the footboard, hold the handlebar and push forward to unfold the scooter.

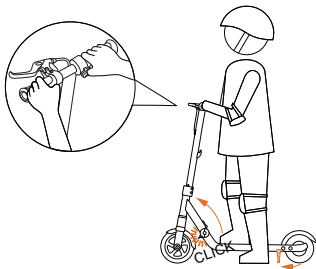

4. Tighten the bolts on the collar clamp. Rotate the accelerator upward to proper position.

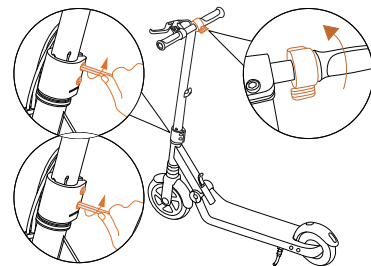

4. Pre-ride Checklist

- Make sure there are no loose fasteners and damaged components. Check all functional parts like the frame, handlebar, tires and make sure the steering system is well adjusted. Ensure that all locking devices are engaged.
- Check the brake for proper function. When you squeeze the brake lever or stamp on the fender brake, there should be positive braking action.
- Battery: if the battery level is low (The buzzer sounds five times.), please fullycharge the battery to ensure normal riding. Always wear a helmet and protective equipment like knee pads and elbow pads. Always wear shoes and proper outfit.
- (sports shoes and clothes are recommended). Never ride barefoot or in sandals. Long hair should be tied back to prevent it from blocking your vision.
- Do not attempt your first ride in any area where you might encounter children, pedestrians, pets, vehicles, bicycles, or other obstacles and potential hazards.
- Check and obey local traffic laws and regulations for scooters.

5. Learn to Ride

WARNING

Always wear a helmet and other protective gear to minimize any possible injury in the learning process.

To reduce the risk of risk of injury, adult supervision is required.

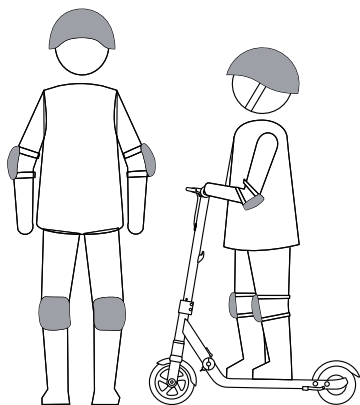

1. Turn on the scooter. If the buzzer sounds five times, please charge immediately.

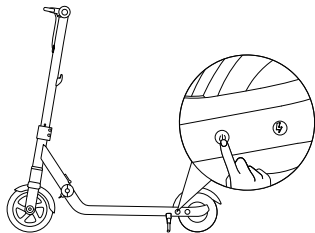

2. Hold the handlebar firmly with both hands. Place one foot on the footboard and start kicking with the other foot.

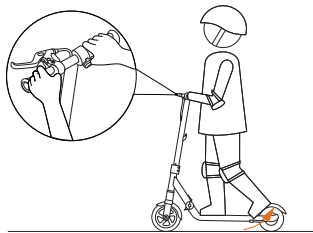

3. When the scooter start cruising, place both feet on the footboard and keep your balance.



4. Accelerate and Decelerate

	Cruise mode	Turbo mode
How to accelerate	kick to go	press the throttle lightly
How to decelerate	squeeze the brake lever and/or step on the fender brake	release the throttle, squeeze the brake lever and/or step on the fender brake

WARNING

Stay alert and avoid abrupt acceleration or deceleration. Otherwise you risk serious injury due to imbalance, loss of traction and falls. **DO NOT** perform stunts of any kind. Both tires must remain on the ground at all times.

Accelerate

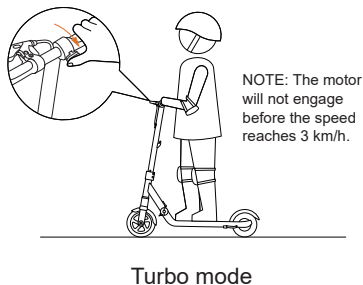
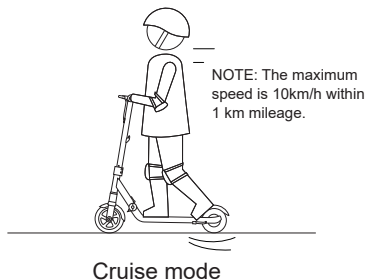

Decelerate

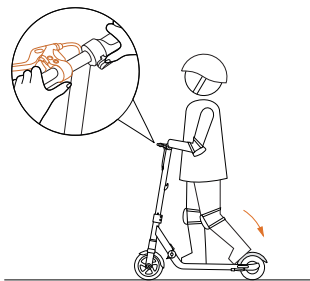

Cruise mode

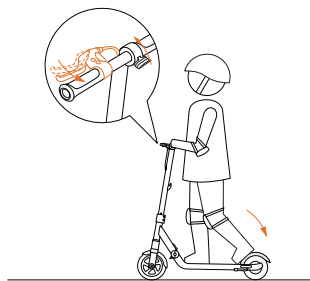

Turbo mode / Safe mode

5. To turn, shift your body and turn the handlebar slightly.

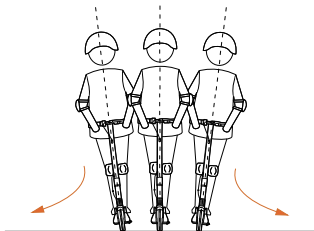

6. When the scooter has stopped cruising, step off one foot at a time. Be extra cautious when dismounting for the first time.

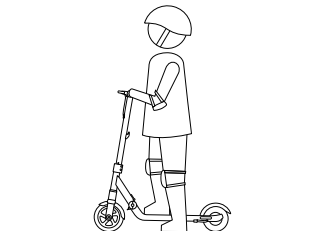

6. Warnings and Cautions

- DO NOT ride on public roads, motorways, or highways.
- DOT NOT ride through bumpy roads or road bumps.

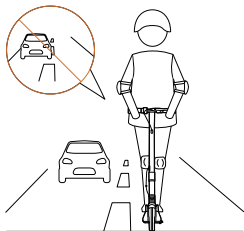

- DO NOT press the throttle when walking along with the scooter
- DOT NOT ride the scooter with only one foot.

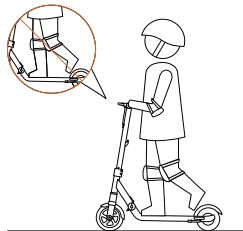
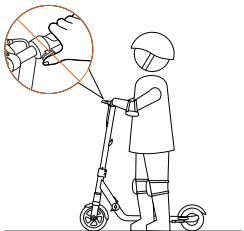

- DO NOT take your hands off the handlebar while riding.

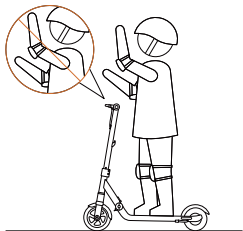

- DOT NOT rotate the handlebar abruptly or violently when riding.

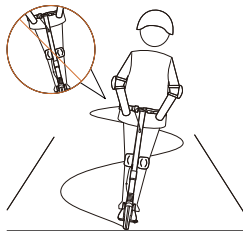

- DO NOT ride in the rain.



- To avoid pinching, DO NOT touch parts with gap.

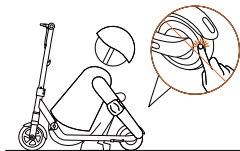

7. Folding and Unfolding

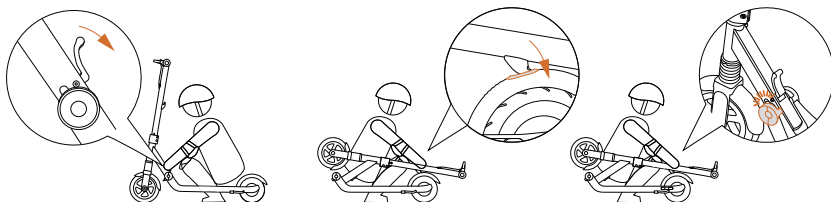

Make sure that the scooter's turned off. To fold, unlock the folding mechanism, and bend the handlebar stem to hook the hanging hole on the fender. To open, remove the hook from the hanging hole on the fender, erect the handlebar and lock the folding structure.

8. Battery

8.1 Temperature Effect on Battery

Battery power will vary with the temperature, mileage per charge will have slight difference under different temperature, and following table is just for your reference.

Temperature(°C)	-20	-10	0	10	20	30	40	50
Range	40%	60%	80%	90%	95%	100%	105%	110%

8.2 Charging

The device has a built-in lithium battery, no extra battery installation is required, just charge the device when it indicates low battery.

Plug in the power source after inserting the charger plug, this can prevent potential risk to ensure a safer charger.

It takes around 4hrs to get 100% charged, when the red lights turn into green, indicating the charging is completed. If not in urgent need, please wait until charging complete before unplugging, for after charging, the protection circuit will perform flow equilibrium.

9. Clean and Maintenance

9.1 Charging

When charging

- Please place the E-scooter in cool and ventilate places to release heat.
- Please avoid high temperature or moist.
- Please avoid water into the E-scooter to prevent electric shock, especially water drops from the charger cable to the the charging port.

When cleaning

- Please make sure the E-scooter is off.
- Please use soft cloth to clean the E-scooter.
- Please don't use water to wash the E-scooter or place E-scooter in water.

When storage

- Please place the E-scooter in cool and ventilate places (temperature $-10\sim 60^{\circ}\text{C}$, relative humidity $0\sim 90\%$).
- Please don't place subjects on the E-scooter or heavy subjects to squeeze the E-scooter.

9.2 Battery Pack Maintenance

Please charge the E-scooter at least one time each month, to extend the battery pack lift time.

Please do not disassemble, assemble or change the battery by yourself.

9.3 Regular Maintenance

Please do not disassemble or assemble the E-scooter without the guide or help from professional maintenance from the seller or distributors.

Please make a video or photo to distributors when the E-scooter run abnormally, as well as providing the serial number.

10. Warranty

10.1 Limited Warranty

Sellers warrant the E-scooter by following limits.

Motor, Controller board for 365 days from the item departure from factory.

Battery package for 183 days from the item departure from factory.

10.2 Exclusion from Warranty

Above limited warranty DOES not include damage or loss not caused by item's defectives (i.e. warranty only covers manufacturer defectives, does not cover any damage, unauthorized modification, improper operation, disassembly etc.)

10.3 After Sale Service

Please contact the local sellers or distributors for after-sale service.

Kingsong Intell Co.,LTD

Address : BLDG 7, NO 71 XINGHU RD, 8TH INDUSTRY PARK,
HONGXING, YUTANG, GUANGMING, SHENZHEN

Tel : +86-755-23193477

Fax : +86-755-23193248

E-mail : info@szkingsong.com